

**BMA Plug (Male) Connector Solder Attachment 4 Hole Flange Mount
Stub Terminal, 6.35mm (.250 inch) Hole Spacing DC-22GHz VSWR1.25**

BMA1GFA50-1800B / 9X

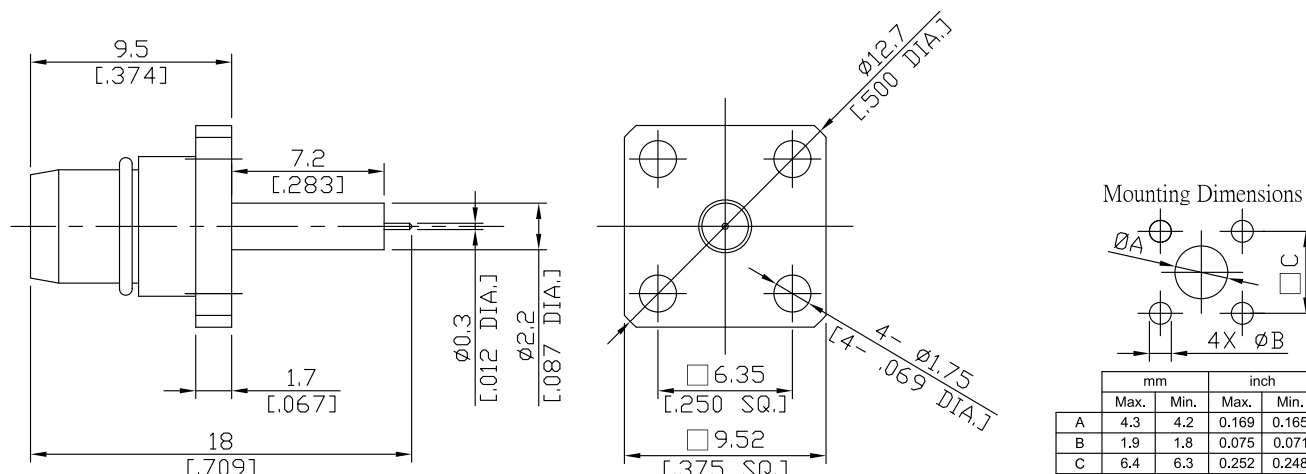

All dimensions are in mm [inch]

Tolerances according to DIN ISO 2768-mH

Interface

According to

MIL-STD-348B/321; IEC 60169-33

Electrical Data

Impedance	50 Ω
Frequency	DC to 22 GHz
VSWR (Return Loss)	≤ 1.25 (≥ 19.08 dB)
Insertion Loss	≤ 0.07 x √F [GHz] dB
Insulation Resistance	≥ 5 x10 ³ MΩ
Center Contact Resistance	≤ 2 mΩ
Outer Contact Resistance	≤ 2 mΩ
Test Voltage	1000 V rms
Working voltage	400 V rms
RF-leakage	≥ 85 dB up to 1 GHz
-VSWR in application depends decisive on PCB layout or cavity design-	

Material And Plating

Piece Parts	Material	Plating
Centre contact	Beryllium Copper	Gold plating (Non-magnetic nickel-phosphorus underplating)
Body	Stainless Steel	Passivated
Insulator	PTFE	
Gasket	Silicone Rubber	

**BMA Plug (Male) Connector Solder Attachment 4 Hole Flange Mount
Stub Terminal, 6.35mm (.250 inch) Hole Spacing DC-22GHz VSWR1.25**

BMA1GFA50-1800B / 9X

Mechanical Data

Coupling Mechanisms	Slide-on
Mating Cycles	≥ 1000
Center Contact Captivation	≥ 27 N
Engagement Force	≤ 13.5 N
Disengagement Force	≥ 2 N
Centre Contact	Soldered
Terminal Type	Stub
Captivated Type	Mechanical

Environmental Data

Temperature Range	-65°C to +165°C
Thermal shock	MIL-STD-202, Meth. 107, Cond. B
Corrosion	MIL-STD-202, Meth. 101, Cond. B
Vibration	MIL-STD-202, Meth. 204, Cond. D
Shock	MIL-STD-202, Meth. 213, Cond. I
Moisture Resistance	MIL-STD-202, Meth. 106
RoHS	compliant

Packing

Single or 100